

See note of checked distances on page 10 also on plate

759.18!! = dist bet Hub's Sta

39+17⁸⁵ = check

510.91 = dist bet Hub's Sta 34+06⁹³ & sulks 27

sulks 27

man take mit following re - 46+76⁸⁵ mit 50.0 ft Chester - down the hill to Hub's Sta

checked distances back

34+06⁹³ Just over Hub B.S. Sta 39+17⁸⁵

band 100.0 ft "brakes"

measured with the steel the two last blocks were

#48 5064.60 (5064.92 - 0.32 = 5064.60)

of 34th Street & County Mt between Hub Sta 39+17⁸⁵ and

A. F. PARKER

This makes the distance

032 South

B36

on to County Mt #48 & Street

Sta 39+17⁸⁵ 90' 00" R + East

34+06⁹³ Just over Hub B.S. on Hub

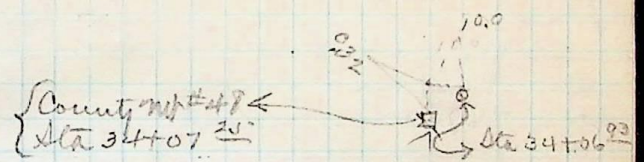

B36

A. F. PARKER.

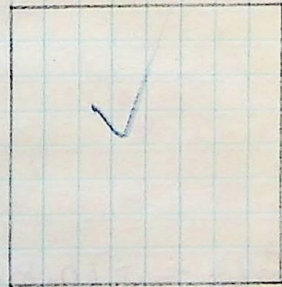

54th

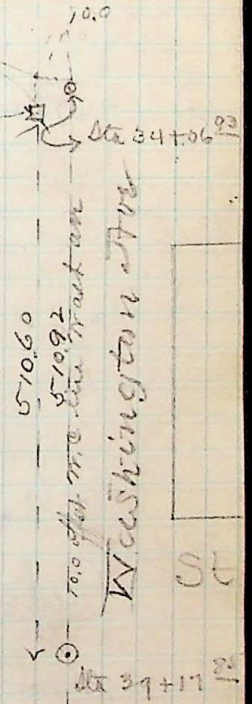

759.2